

User's Manual

BlüeNEXT

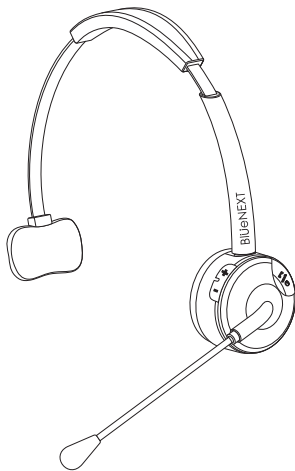

BN666
Bluetooth Headset

1 *Notice Before Using*

Thank you for purchasing the Bluetooth Headset BN666. Please check the contents of this package to verify the items listed below have been included in your package. Please read this User's guide completely before you use the Headset. The BN666 has been developed using Bluetooth wireless technology and is capable of connecting with Bluetooth devices designed with Audio Gateway. PDAs, Desktop and Notebook computers can be connected and paired with the Headset using a USB Bluetooth Dongle. Before using the Headset please verify your Bluetooth device (Phone, PDA) complies with Bluetooth V1.1/V1.2/V2.0/2.1 and supports the Bluetooth Headset or Hands-free profile.

2 *Package Contents List*

Please inspect this package and refer to the package contents list below to verify all items were included in this package:

Item Name	Quantity
A. BN666 Bluetooth headset.....	1
B. DC Car Charger.....	1
C. USB Charging Cable.....	1
D. User manual.....	1
E. Ear Pad (Large and Small).....	2

3 *BN666 Bluetooth Headset Overview*

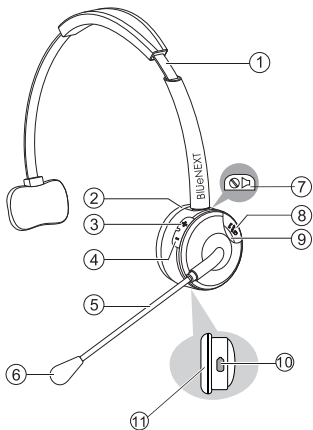

1. Adjustable Head Strap

2. Speaker

3. Volume(+)

4. Volume(-)

5. Flexible Arm

6. Microphone Boom (MIC)

7. Mute Button

8. On/Off Button

9. Indicator Light (LED)

10. Charging Socket (Micro USB)

11. Ear Pad

4 *Charging the battery*

This headset has an internal, non-removable, rechargeable battery. Do not attempt to remove the battery from the device as you may damage the device. Please refer to the following steps to charge the battery:

1. Connect the charger to the correct outlet.
2. When the charger is connected to the headset, the red indicator light will turn on indicating it is charging. If charging does not start, disconnect the charger, plug it in again. Charging the battery fully may take up to 2 hours.
3. When the battery is fully charged, the red indicator light will turn off. Disconnect the charger from the headset and the wall outlet. The headset is ready to use.

NOTE:

- The fully charged battery has power for up to 10 hours of talk-time or up to 200 hours of standby time. However, the talk and standby times may vary when used with different mobile phones or other compatible Bluetooth devices, usage settings, usage styles, and environments.
- When the battery power is low, the headset will remind you by beeping every 20 seconds, and the red indicator light starts to flash.
- For first time use, please charge the headset fully. If you can not see the indicator light while charging, please leave the headset on the charger for a while, and then the indicator light will turn on.

5 Pair to your Bluetooth phone

Before you use your headset the first time, you must pair the unit with a Bluetooth enabled mobile phone.

Please refer to the following steps to set up the pairing:

1

Insure the headset is off.

2

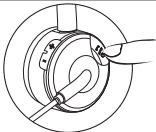

Press and hold the **On/Off** button on the edge of the unit for 4 seconds until you see the LED light flash blue and red alternately indicating the unit is in pairing mode.

3

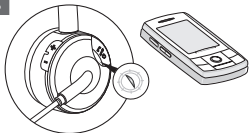

Following your phone's instruction guide, set your Bluetooth enabled phone into search mode

4



Your phone will find the headset and show the device name on the screen, select the device name to confirm pairing.

5



Enter **PIN code as 0000** (4 zeros) and confirm to complete pairing.

NOTE:

- If the pairing is successful, the headset will connect to your phone automatically. You may need to confirm the connection.
- While the headset is paired with the phone and connected, the indicator light will flash blue 1 time every 3 seconds. If the pairing operation failed or did not connect to your phone, the blue indicator light will flash 1 time every 5 seconds.
- Once you pair the headset with one device or more, the Headset will automatically connect to the phone you last connected whenever you turn the headset on, as long as, your phone is within range and has its Bluetooth function enabled.

6 *Battery information*

- ✧ Your device is powered by a chargeable battery. The full performance of a new battery is achieved only after two or three complete charge and discharge cycles. The battery can be charged and discharged hundreds of times.
- ✧ Unplug the charger from the electrical plug and the device when not in use. Do not leave a fully charged battery connected to a charger, since overcharging may shorten its lifetime. If left unused, a fully charged battery will lose its charge over time. If the headset will go unused for a long time, please charge fully and turn off the headset.
- ✧ To prevent over discharge endangering the battery, you are recommended to charge the headset fully each month.

7 *Turning headset on /off*

***Turning on your headset**

While the headset is turned off, press and hold **On/Off** for 3 seconds until you hear a tone from low to high. The headset is now on. The Blue indicator light will be solid for 2 seconds.

***Connecting to a Bluetooth phone**

If your headset has completed the pairing operation successfully, when the headset is turned on, it will connect to the phone you last connected with automatically. Please ensure your phone's Bluetooth function is active.

***Turning off the headset**

At any working state after the headset is powered on, press and hold **On/Off** for 5 seconds. You will hear a tone from high to low, and the Red indicator light will be solid for 4 seconds. The headset has now powered off.

Note:

To conserve power, if the headset is not connected to a device for approximately one (1) hour, the headset will turn off automatically.

8 *Wearing your headset*

According to your preference, you can wear the headset on your left or right ear. The adjustable head strap design allows for a comfortable fit.

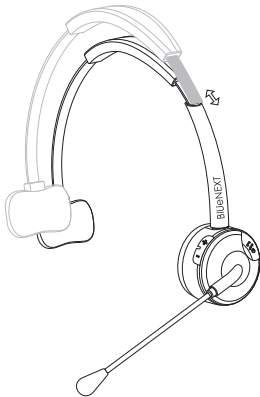

9 *Disable/Enable the LED indicators*

Press and hold the **MUTE** button for 3 seconds while the headset is in any powered on state. The LED indicators will be turned off. Repeat this action to activate the indicators. The headset will flash BLUE 2 times to confirm re-activation of LED was successful.

10 *Making a call*

*** Using phone's keypad**

In stand-by mode, dial the number on your phone's keypad to make a call.

*** Use Voice-Dialing**

In the stand-by mode, press the **On/Off** shortly, you will hear a short tone from the headset, and the phone will prompt you to say the voice tag which you have already attached to your contact. If the voice tag is identified by the phone, the related number will be dialed.

Please insure that your mobile phone supports this voice dialing function, and voice tags have been set up on your mobile phone prior to attempting this. Refer to your mobile phone's user guide or contact your service provider.

*** Last number re-dialing**

Press and hold the **Volume(-)** button for 3 seconds. You will hear 2 short tones.

The last number you dialed will be re-dialed.

11 *Answering a call*

When you receive an incoming call, press the **On/Off** button shortly to answer the incoming call; you can also answer the call on your phones keypad.

12 *Reject an incoming call*

When you receive an incoming call, press and hold **On/Off** button for 3 seconds to reject the incoming call.

13 *Transferring a call*

While a call is in progress on your mobile phone, press and hold **Volume (+)** for 3 seconds. The call will be transferred from your mobile phone to your headset. Repeating the operation can transfer the call between your headset to your mobile phone.

14 *Ending a call*

While on a call, press the **On/Off** button shortly to end the call; you can also end the call on your mobile phone keypad.

15 *Call-waiting (Three-Way Calling)*

Before using the Call-Waiting function on your headset, please ensure that your phone supports this Hands-free profile and you have access to the service by wireless provider.

- * If there is another incoming call while a call is in progress on your mobile phone, press **On/Off** shortly. This will accept the waiting call and end current calling.
- * If there is an incoming call while a call is in progress on your mobile phone, press and hold **On/Off** for 3 seconds to accept the incoming call and place the current call on hold.
- * While a call is on hold and you are engaged in an additional call, press **On/Off** shortly to end the current call and resume the call holding.
- * While a call is on hold and you are engaged in an additional call, press and hold **On/Off** for 3 seconds to shift the current call to hold and connect you with the previously held call.
- * While you are engaged in one call with another call on hold, press the volume-up button and volume-down button shortly to add the held call to the current conversation making a three-way call.
- * While you engaged in a three-way call, double press **On/Off** to end all calls.

16 *Volume control*

While on a call, you can adjust the volume by pressing the **Volume(+)** and **Volume(-)** button or you can adjust the volume on your mobile phone keypad.

17 *Mute*

While a call is in progress press the **Mute** button, you will hear a tone from low to high. The headset's MIC is now muted. You will hear a remindful tone every 20 seconds, notifying you that your MIC is still muted and a call is still in progress. Repeat the operation and you will hear the tone from high to low. The mute function is now cancelled.

18 *Safety and general information*

1. Please read this User's Manual carefully and follow all instructions.
2. To avoid any damage or malfunction of the device do not drop the device from high places.
3. Keep device away from humidity, water and any other liquid. If the device is exposed to water, moisture and other liquids do not operate it to avoid any electrical shock, explosion and damage to the device or yourself.
4. Do not place or keep this device near any heat sources, such as, direct sun light, radiators, stoves or other apparatus which produce heat. It may cause an explosion, degrade the performance and/or reduce battery life.
5. Do not modify, repair or disassemble device (Especially the battery: It may cause an explosion). Doing this will void the warranty.
6. Do not place heavy objects on the device.
7. Use only supplied and approved charger.
8. Replacement or service must be done by a qualified service center or manufacturer.
9. Unplug this device when unused for long periods of time or during lightening storms.



CAUTION: ELECTRIC SHOCK HAZARD

The battery used in this device may present a risk of fire or chemical burn if mistreated.

19 *FCC & IC Statement*

Operation is subject to the following two conditions:

- (1) This device may not cause harmful interference.
- (2) This device must accept any interference received, including interference that may cause undesired operation.

Note: The manufacturer is not responsible for ANY interference, for example RADIO or TV interference, caused by unauthorized modifications to this equipment. Such modifications could void the user's authority to operate the equipment.

20 **EU**

This product is CE certified according to the provision of the R&TTE Directive (99/5/EC). This declares that this product is in compliance with the essential requirements and other relevant provisions of Directive 1999/5/EC.

Please note that this product uses radio frequency bands not harmonized within EU. Within the EU this product is intended to be used in Austria, Belgium, Denmark, Finland, France, Germany, Greece, Ireland, Italy, Luxembourg, The Netherlands, Portugal, Spain, Sweden, and United Kingdom and within EFTA in Iceland, Norway and Switzerland.

Bluetooth is a trademark owned by the Bluetooth SIG, Inc.

21 Warranty

The condition of this warranty and supplier's responsibilities under this warranty are as follows:

Warranty is non-transferable and is limited to the original purchaser only.

- You must be able to prove the date of original purchase of the unit with a dated receipt.
- The warranty is not applicable if the product has been subject to physical abuse, improper installation, modification or repair by an unauthorized third party.
- Supplier's responsibility shall be limited to the repair or replacement of the product at its sole discretion.
- Specifically exempt from any warranty are limited-life consumable components subject to normal wear and tear such as batteries, decorates and other accessories.
- Supplier is not responsible, for failure resulting from accident, abuse, misuse, or any unauthorized repair, or modification.
- Modification and repair of the unit should be done by an authorized and qualified service center or returned to the manufacturer
- This warranty gives you specific legal rights, and you may also have other rights which vary under local laws.

BlüeNEXT

Hayat and Hu Corporation Ltd

Customer Technical Support

T: +44 1706 366332

E: info@bluenext.co.uk

W: www.bluenext.co.uk